

Angular Contact Ball Bearings

Brass cage angular contact ball bearing-7322 BECBY

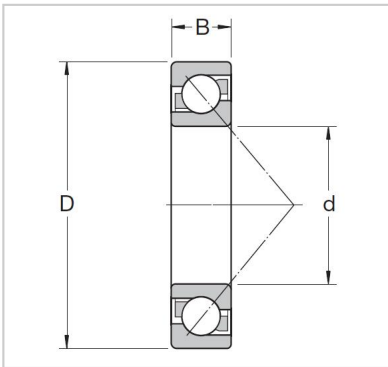

Abutment and fillet dimensions

Db max.	7322 BECBY
Da max.	7322 BEY
da min.	110
rb max.	240
ra max.	50

Dimensions

a	225
r3,4 min.	224
r1,2 min	7.2
D1	3 200
d2	3 200
d1	10

Mass

KG	160
----	-----

Speed ratings r/min

Limiting speed	135
Reference speed	194

Fatigue load limit

Pu kN	3
-------	----------

Basic load ratings KN

dynamic C kN	1.1
static Co kN	99

Basic design bearing

B mm	124
D mm	226
d mm	233

Basic design bearing

2.5	
-----	--

Designations

Universally matchable bearing	1
-------------------------------	---